

Agricultural Land Classification

NORTHUMBERLAND

MINERALS LOCAL PLAN

Ridley Hall



Agricultural Land

Grade	Quality	Area (ha)
1	Excellent	Nil
2	Very Good	57.9
3a	Good	17.2
3b	Moderate	8.0
4	Poor	0.9
5	Very Poor	Nil

Other Land Categories

Category	Area (ha)
Urban	Nil
Non-Agricultural	1.7
Woodland	5.6
Agricultural Buildings	Nil
Open Water	Nil
Not Surveyed	Nil

Total agricultural land area 84.0
Total survey area 91.3

* Grade/category not present within survey area

Scale - 1:10,000

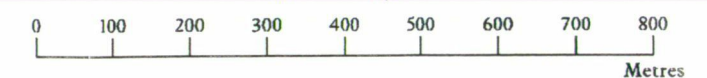

Further details contained in MAFF (1988) Agricultural Land Classification of England and Wales - Revised guidelines and criteria for grading the quality of agricultural land. MAFF (Publications), London SE99 7TP.

The information is accurate at the base map scale but any enlargement would be misleading.

Reproduction in whole or in part by any means is prohibited without the prior permission of MAFF.

Surveyed and drawn by the Resource Planning Team, ADAS Statutory Unit Leeds
Based on the 1981 Ordnance Survey 1:10,000 map with the permission of the Controller of Her Majesty's Stationery Office.
Source Map(s): NY 76 NE, NY 76 SE, NY 86 NW, NY 86 SW.
Reference no. 80/95 © Crown Copyright Reserved 1995

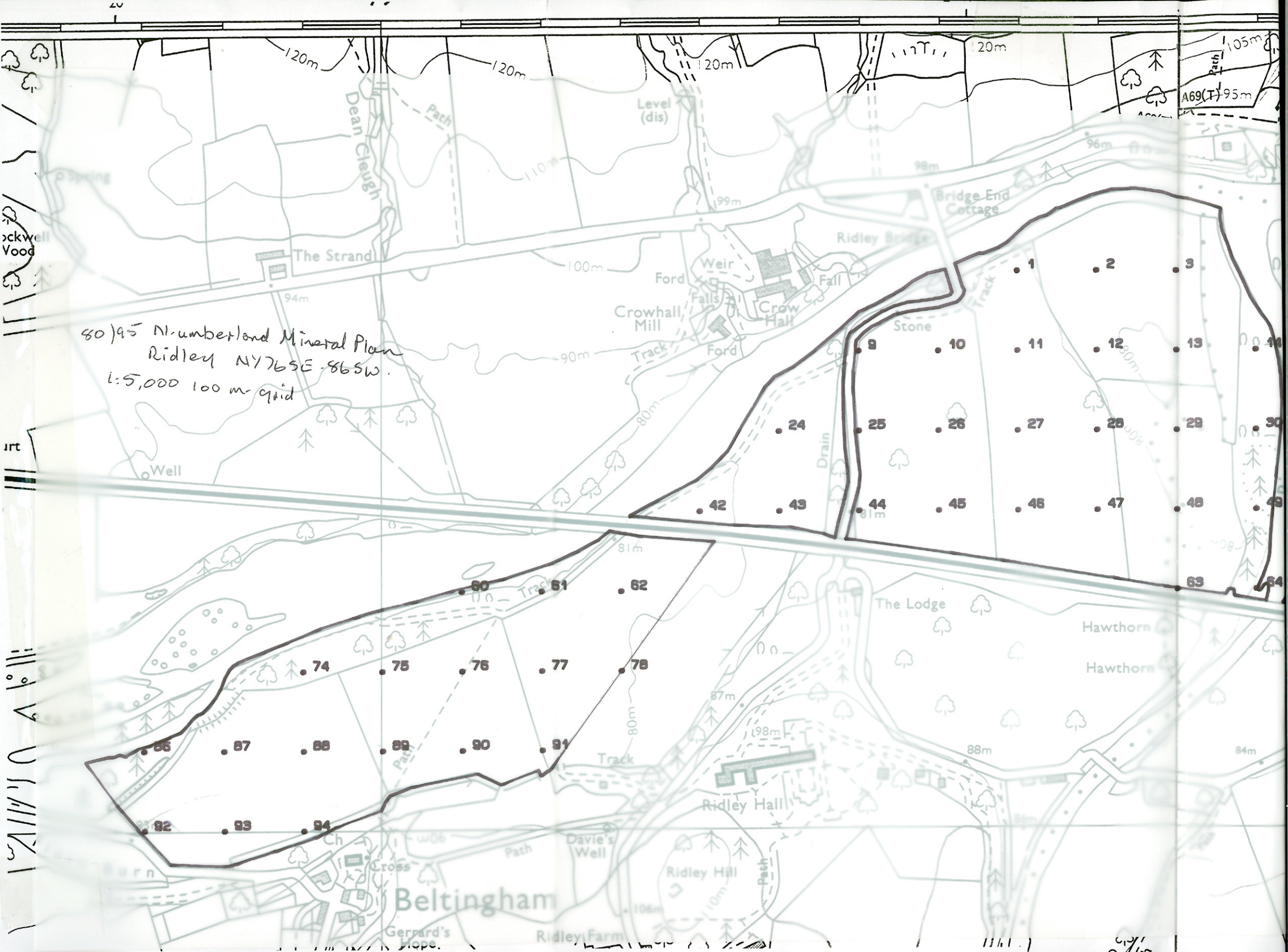

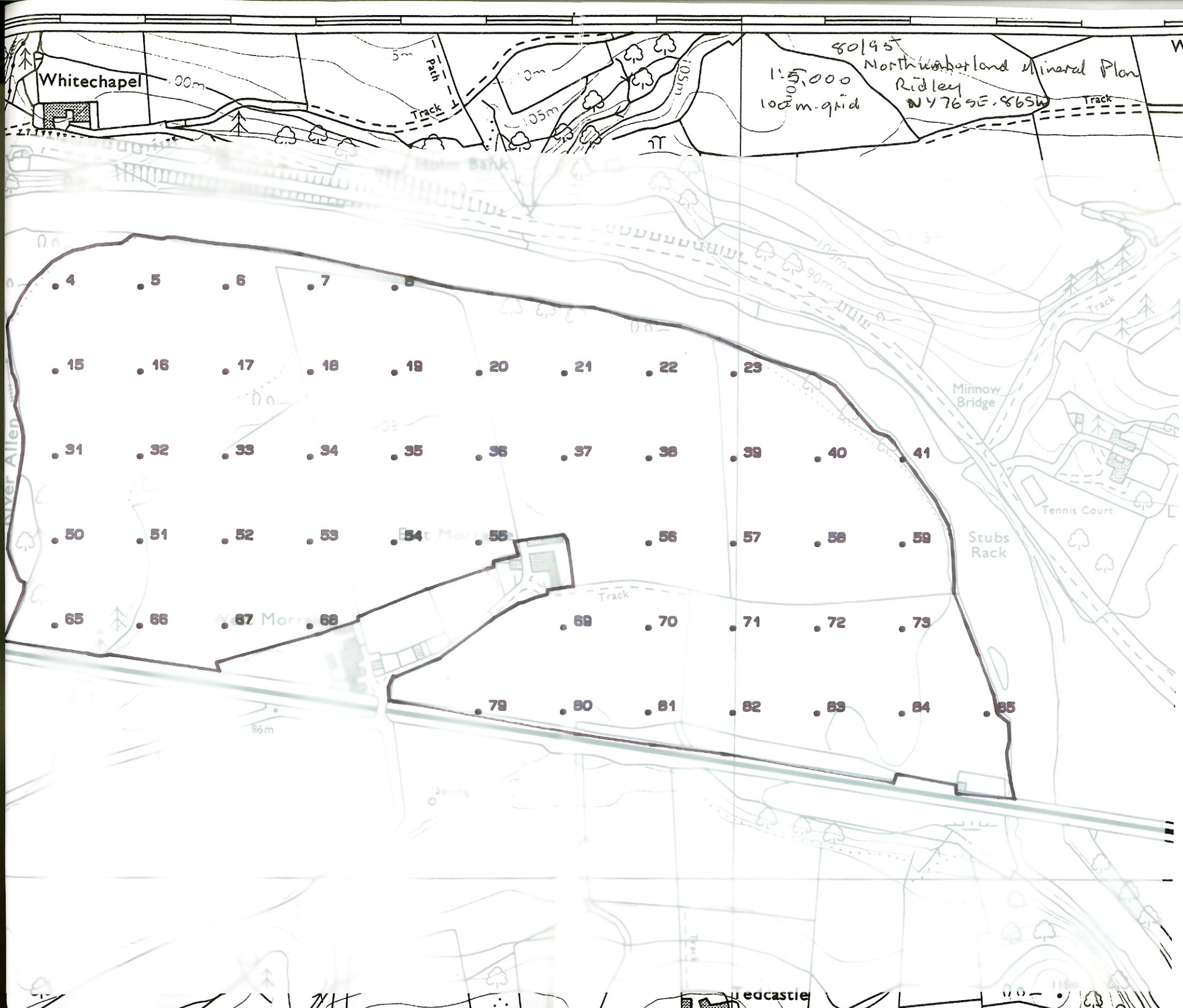

Whitechapel

80/95
Northumberland Mineral Plan
1:5,000
100m grid
Ridley
N 476 SE. 86 SW

- 4 5 6 7 8
- 15 16 17 18 19 20 21 22 23
- 31 32 33 34 35 36 37 38 39 40 41
- 50 51 52 53 54 55 56 57 58 59
- 65 66 67 68 69 70 71 72 73
- 79 80 81 82 83 84 85

Minnow Bridge

Tennis Court

Stubbs Rack

Redcastle