

Tunbridge Wells Local Plan: Site 2: Land West of Farnham Lane, Langton Green, Speldhurst, Kent

Agricultural Land Classification

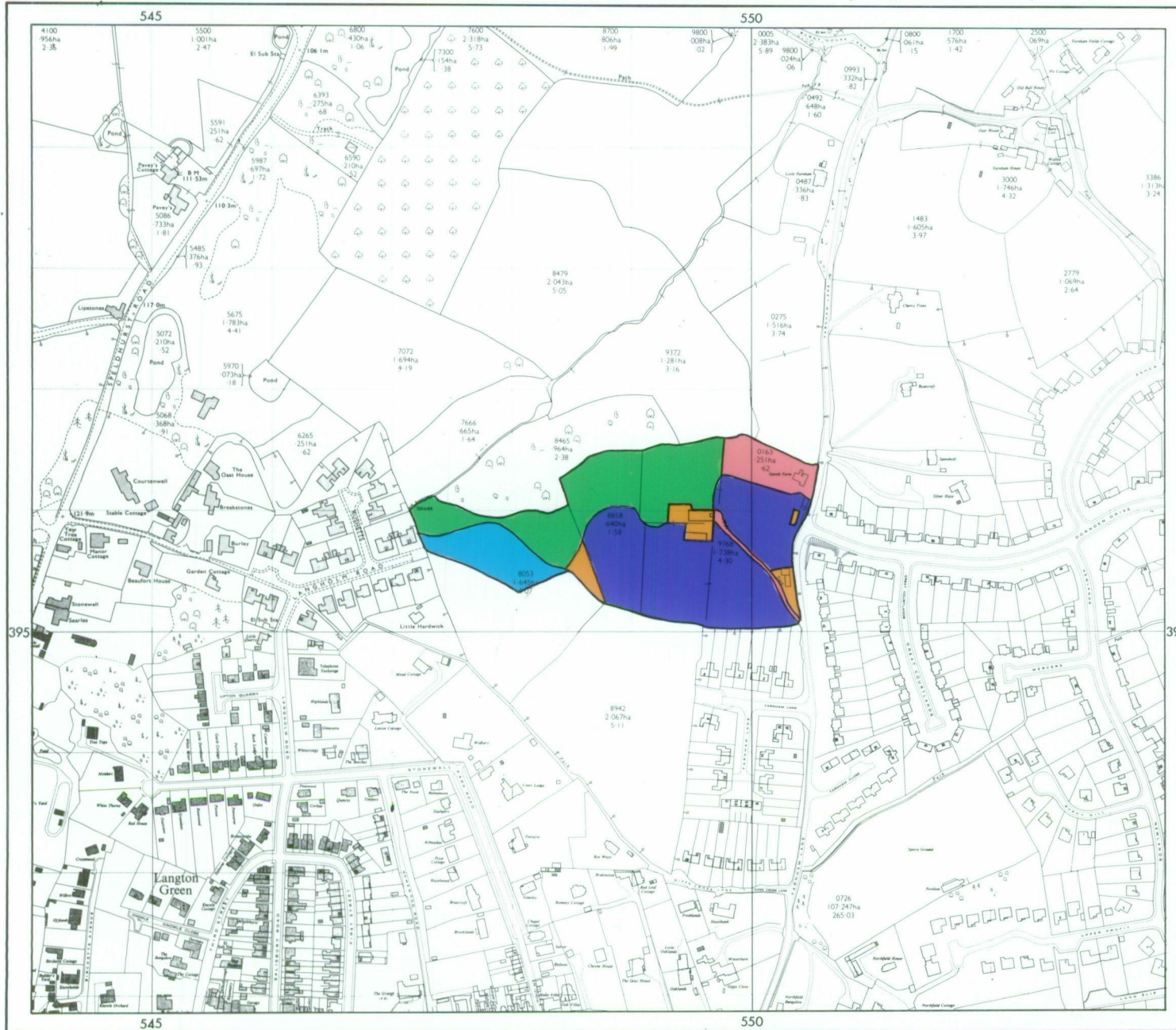

AGRICULTURAL LAND

Grade	Quality	Area	% of Total
Grade 1	excellent	1.6ha	53%
Grade 2	very good	.32ha	11%
Grade 3a	good	ha	%
Grade 3b	moderate	1.07ha	36%
Grade 4	poor	ha	%
Grade 5	very poor	ha	%

Total area of agricultural land surveyed 2.99 ha

Agricultural buildings	Not present
Woodland	Not present
Not surveyed	Not present

NON-AGRICULTURAL LAND

Land predominantly in urban use	
Land in non-agricultural use	
Total area of site	3.47 ha

For further information consult "Agricultural Land Classification of England and Wales (Revised guidelines and criteria for grading the quality of agricultural land)", M.A.F.F., 1988.

SOURCE MAPS

TQ 5439-5539

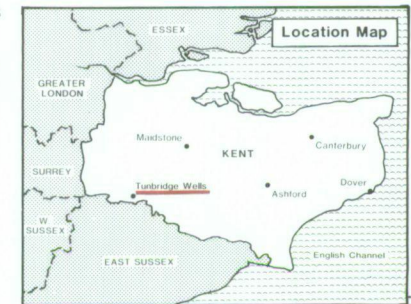

Surveyed by the Resource Planning Team 6/92
Map compiled and produced by the Cartographic Unit, Resource Planning Team, Guildford Statutory Group, Agricultural Development and Advisory Service.
Reference no. 2014/128/92 MAFF Reference no.

Ordnance Survey information reproduced with the sanction of the Controller, H.M.S.O.

Reproduction of this map in whole or in part is prohibited without the prior permission of M.A.F.F.

This map is accurate only at the scale shown.

© Crown Copyright reserved 1992

Tunbridge Wells Local Plan

Site 2: Land West of Farnham Lane, Langton Green, Speldhurst, Kent

Location of Auger Borings

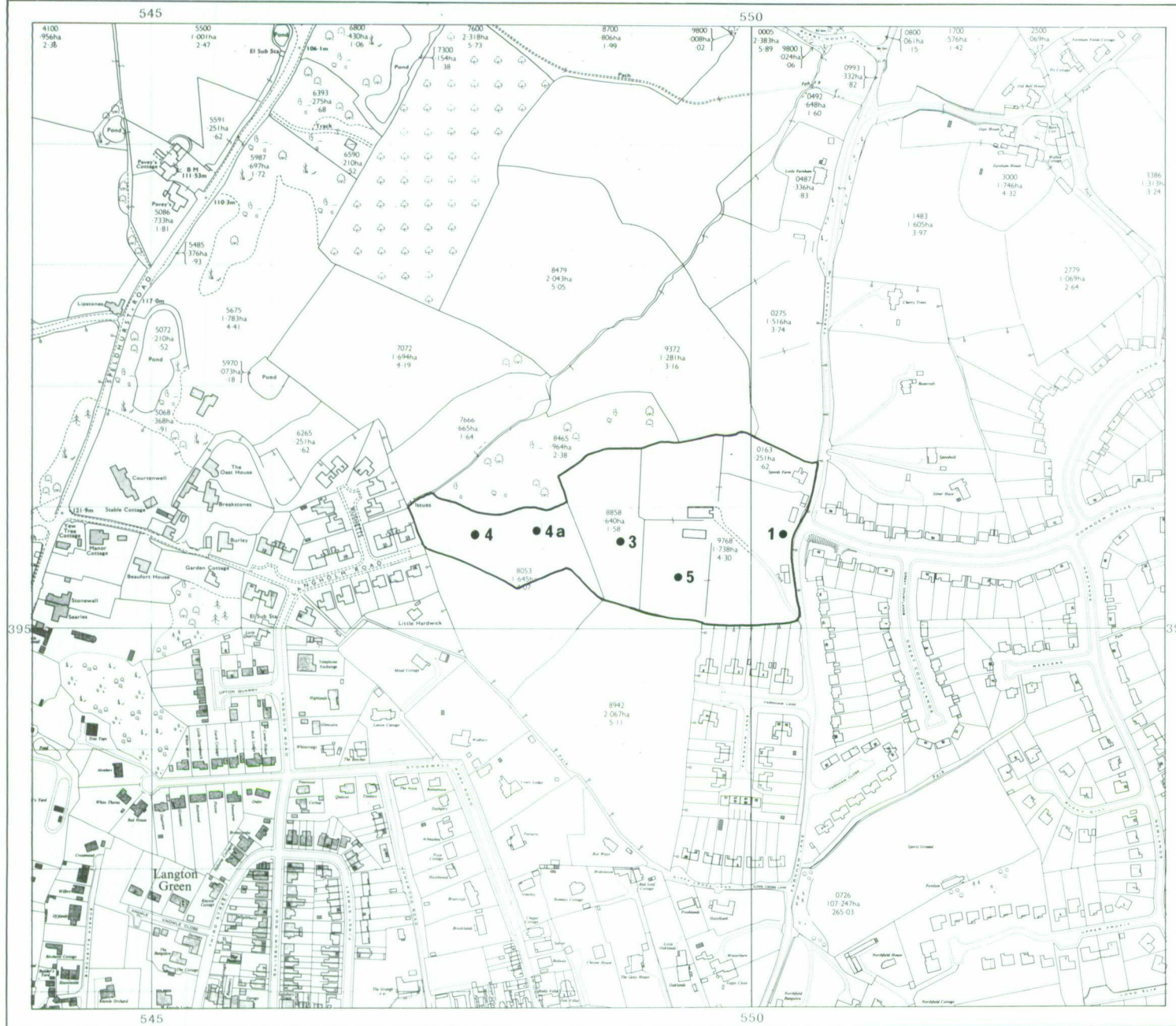

• 5 Auger boring

Surveyed by the Resource Planning Team, 6/92
 Map compiled and produced by the Cartographic Unit,
 Resource Planning Team, Guildford Statutory Group,
 Agricultural Development and Advisory Service.
 Reference no. 2014/128/92 MAFF Reference no.

SOURCE MAPS
TQ 5439-5539

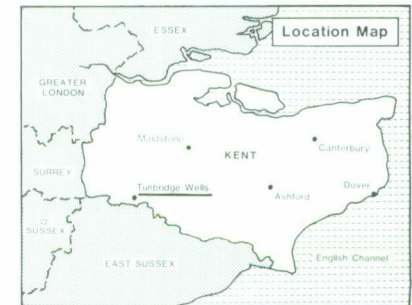

Ordnance Survey information reproduced with the sanction of the Controller, H.M.S.O.

Reproduction of this map in whole or in part is prohibited without the prior permission of M.A.F.F.

This map is accurate only at the scale shown.

