

Elburton, Plymouth

SEMI-DETAILED SURVEY
Some grade boundaries may be subject to revision after detailed resurvey

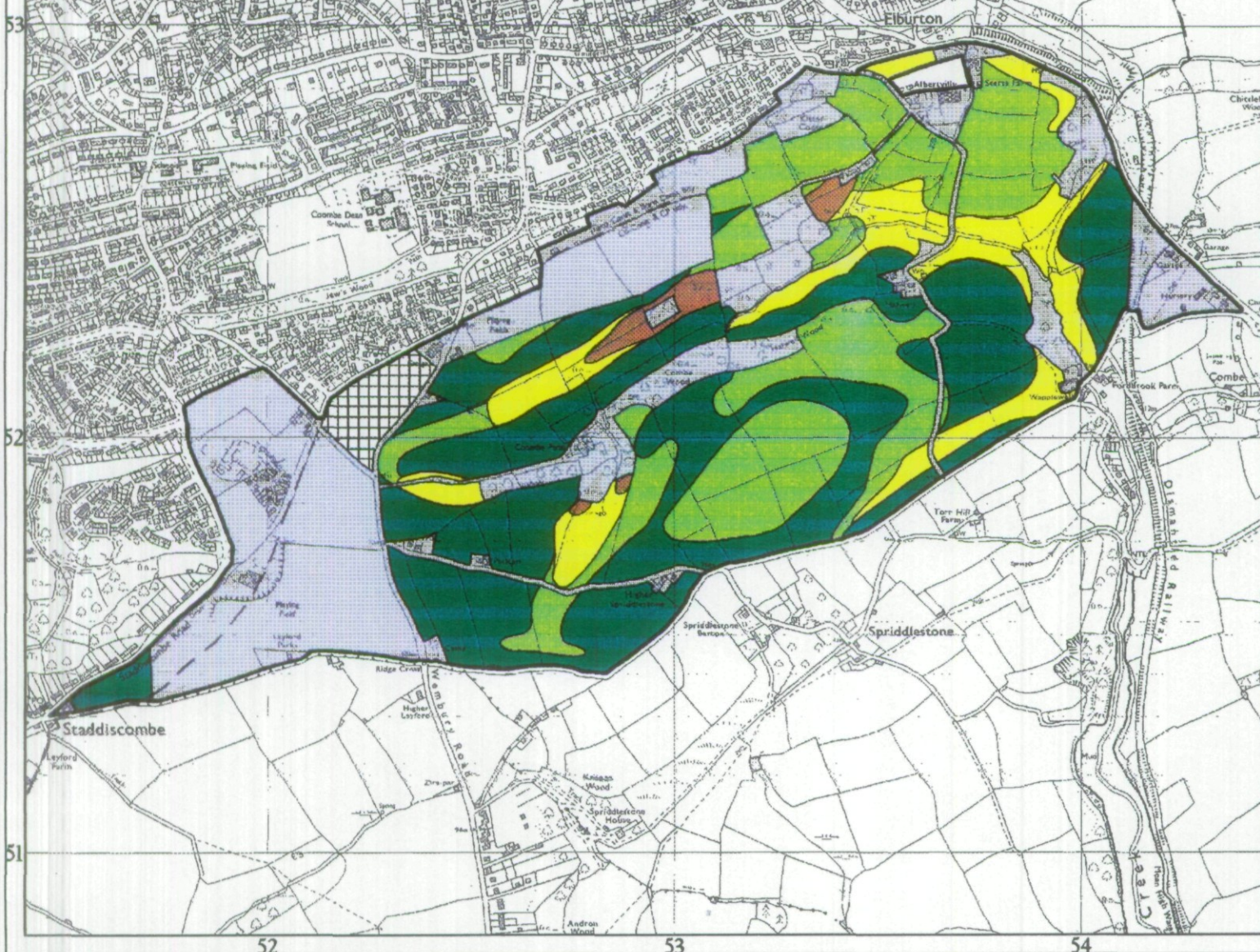

| Legend | | |
|----------------------------------|--------------------------------|-----------|
| | Quality | Area (ha) |
| Grade 1 | Excellent | 0.0 |
| Grade 2 | Very Good | 0.0 |
| Grade 3a | Good | 65.1 |
| Grade 3b | Moderate | 45.4 |
| Grade 4 | Poor | 21.6 |
| Grade 5 | Very Poor | 3.2 |
| | Agricultural land not surveyed | 3.8 |
| | Other land | 73.5 |
| Boundary of survey area | | |
| Total agricultural land area | | 139.1 |
| Total survey area | | 212.6 |
| * Not present within survey area | | |

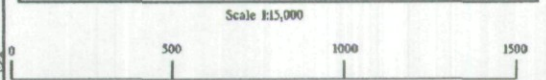



Further details contained in MAFF (1988) Agricultural Land Classification of England and Wales - Revised guidelines and criteria for grading the quality of agricultural land. MAFF (publications), London SE99 7TP. The information is accurate at base map scale but any enlargement would be misleading. Reproduction in whole or in part by any means is prohibited without the prior permission of MAFF.

Surveyed and drawn by the Resource Planning Team, FRCA Western Region. Based on the 1989 Ordnance Survey 10000 map with the permission of the Controller of Her Majesty's Stationery Office. Unauthorised reproduction infringes Crown copyright and may lead to prosecution or civil proceedings. MAFF Licence No: GD272361 Source map(s): SX55SW Reference no: 55/98 © Crown Copyright Reserved 1998

Elburton, Plymouth

Sample Point Map

Legend

-  1 Location of soil pit
-  1 Location of auger sample point

 Boundary of survey area

 Agricultural land not surveyed

 Other land

Scale 1:15,000

0 500 1000 1500

Further details contained in MAFF (1988) Agricultural Land Classification of England and Wales - Revised guidelines and criteria for grading the quality of agricultural land. Maff (publications), London SE99 7TP. The information is accurate at base map scale but any enlargement would be misleading. Reproduction in whole or in part by any means is prohibited without the prior permission of MAFF.

Surveyed and drawn by the Resource Planning Team, FRCA Western Region. Based on the 1989 Ordnance Survey 10000 map with the permission of the Controller of Her Majesty's Stationery Office. Unauthorised reproduction infringes Crown copyright and may lead to prosecution or civil proceedings. MAFF Licence No: GD272361 Source map(s): SX55SW Reference no: 55/98 © Crown Copyright Reserved 1998

