

Agricultural Land Classification

Oasis Site, Great Bromley, Essex

Legend

	Quality	Area (ha)
Grade 1	Excellent	nil
Grade 2	Very Good	9.9
Grade 3a	Good	nil
Grade 3b	Moderate	nil
Grade 4	Poor	nil
Grade 5	Very Poor	nil
*	Agricultural land not surveyed	nil
▨	Other land	0.5
—	Boundary of survey area	
Total agricultural land area		9.9
Total survey area		10.4
* Not present within survey area		

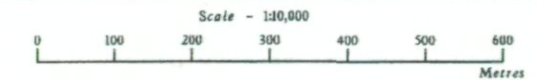

Further details contained in MAFF (1988) Agricultural Land Classification of England and Wales - Revised guidelines and criteria for grading the quality of agricultural land. MAFF (publications), London SE99 7TP. The information is accurate at base map scale but any enlargement would be misleading. Reproduction in whole or in part by any means is prohibited without the prior permission of MAFF.

Surveyed and drawn by the Resource Planning Team, ADAS Statutory Unit, Huntingdon.
Based on the '78-'84 Ordnance Survey 1:50 000 map with the permission of the Controller of Her Majesty's Stationery Office. Unauthorised reproduction infringes Crown copyright and may lead to prosecution or civil proceedings. MAFF Licence No: GD272361
Source maps: TM02NE, TM02SE, TM12NW & TM12SW
Reference no: 016 197 © Crown Copyright Reserved 1997

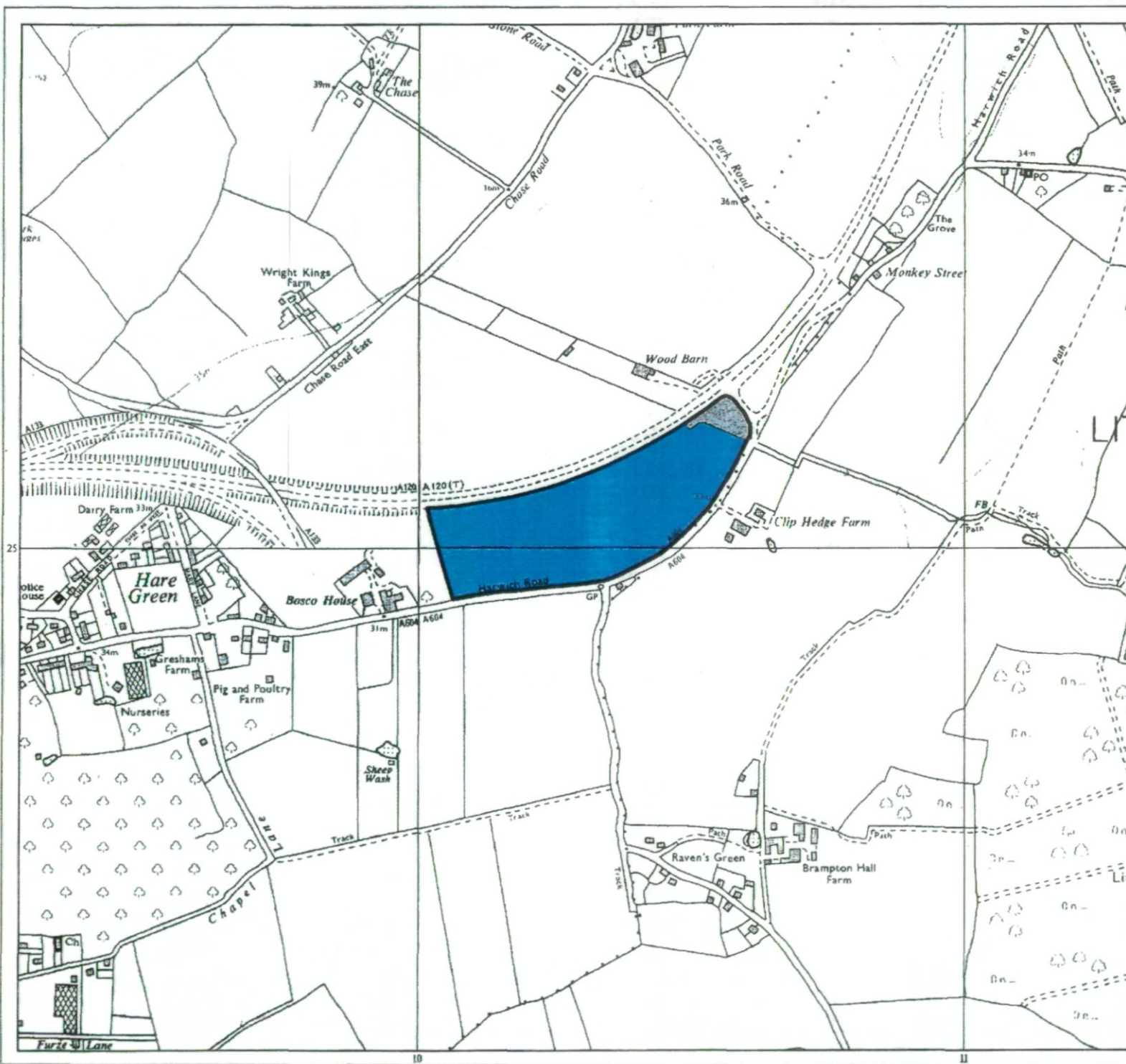

Agricultural Land Classification

Oasis Site, Great Bromley, Essex

Sample Point Map

Legend

 1 Location of soil pit

 1 Location of auger sample point

 Boundary of survey area

 Agricultural land not surveyed

 Other land

Scale - 1:30,000

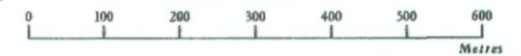

Further details contained in MAFF (1988) Agricultural Land Classification of England and Wales - Revised guidelines and criteria for grading the quality of agricultural land. Maff (publications), London SE99 7TP. The information is accurate at base map scale but any enlargement would be misleading.

Reproduction in whole or in part by any means is prohibited without the prior permission of MAFF.

Surveyed and drawn by the Resource Planning Team, ADAS Statutory Unit, Huntingdon.
Based on the '78-'84 Ordnance Survey 1:10 000 map with the permission of the Controller of Her Majesty's Stationery Office. Unauthorised reproduction infringes Crown copyright and may lead to prosecution or civil proceedings. MAFF Licence No: GD272361
Source maps: TM02NE, TM02SE, TM12NW & TM12SW
Reference no: 016197 © Crown Copyright Reserved 1996

