

Agricultural Land Classification

Covenbrook Hall Farm, Essex

AGRICULTURAL LAND

Agricultural Grades

Agricultural Land Quality

Grade 1



Very high

Grade 2



Grade 3

a



b



Grade 4



Grade 5



Very low

Disturbed



Agricultural Buildings



Unsurveyed



NON AGRICULTURAL LAND

Land predominantly in urban use



Other land primarily in non-agricultural use



* Land in this category does not occur on this map

SOURCE MAPS Base maps taken from the O.S. 1:10000
Sheet TL 72 SE

This map is accurate only at the scale shown.
Any enlargement could be misleading

Scale 1:10000

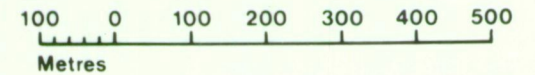

Drawn by the Cartographic Unit,
Farm & Countryside Service
Cambridge, Ref. C 16 90
Ordnance Survey maps reproduced
with the permission of the Controller,
H.M.S.O.
© Crown Copyright reserved 1990

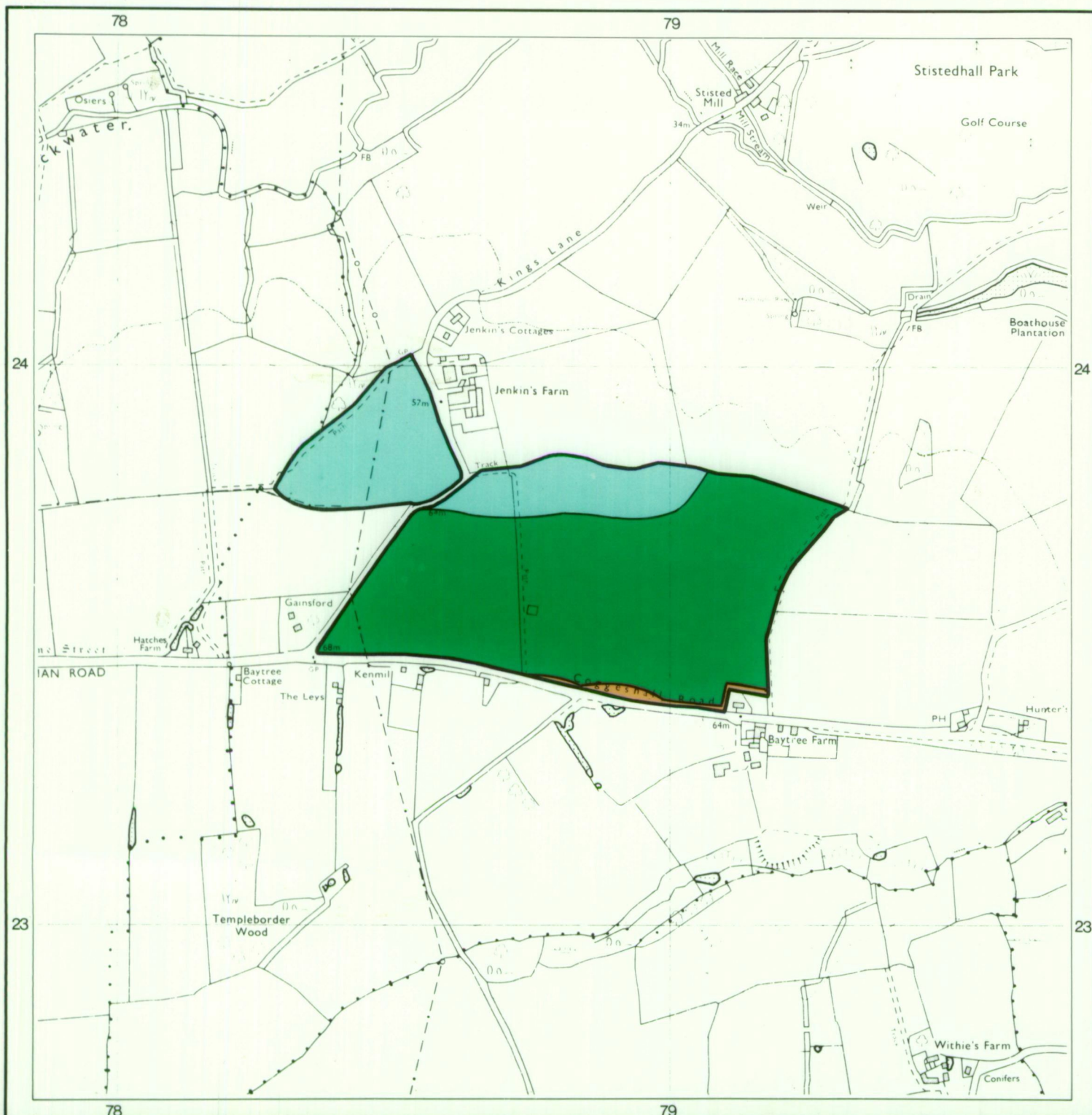

16/90

Covenbrook Hill
1:5000

FINAL A BORINGS

PIT LOCATIONS

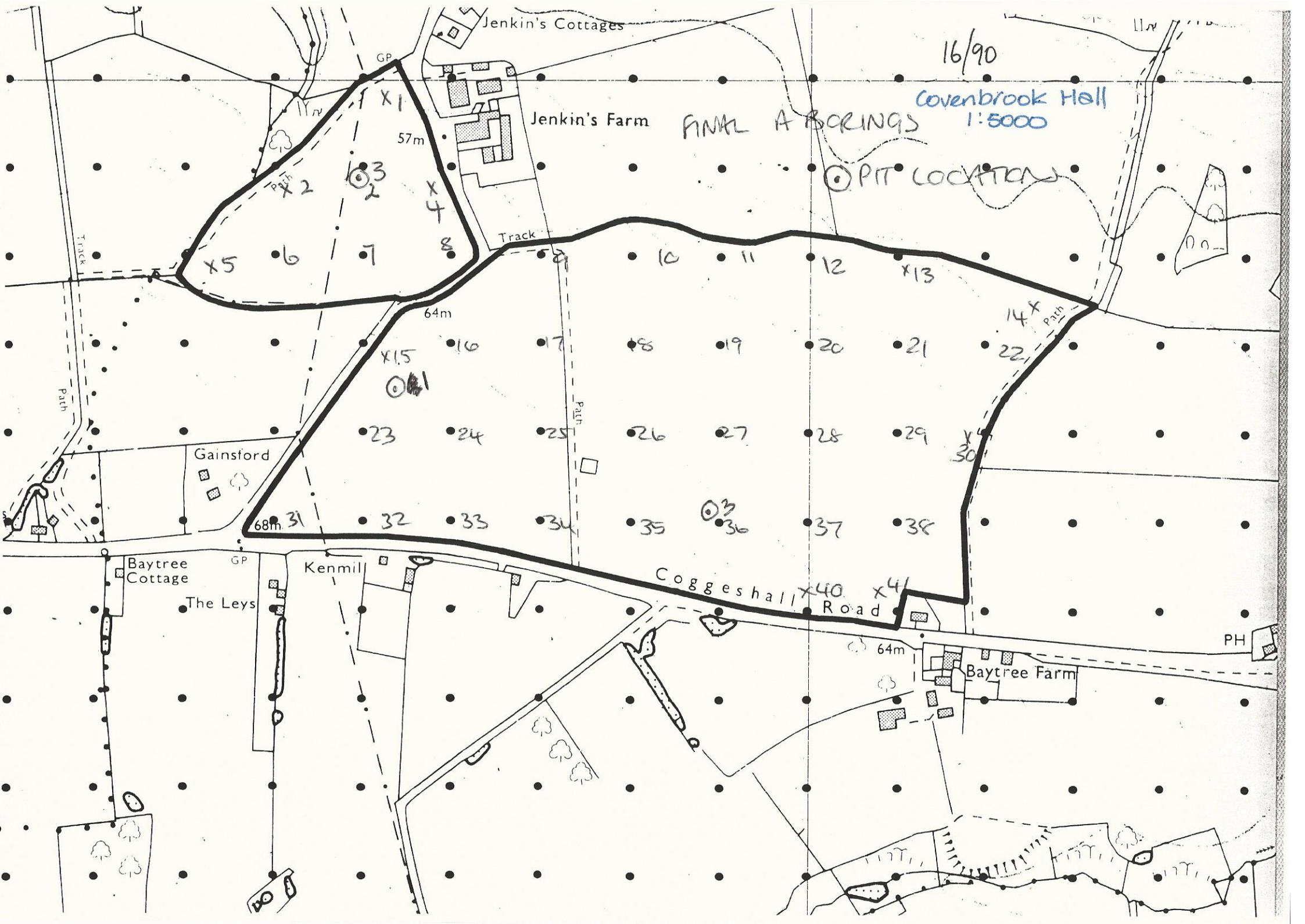

Agricultural Land Classification

Covenbrook Hall Farm, Essex

SOIL TYPES

SOIL TYPE	TOPSOIL 0 - 30/35cm	UPPER SUBSOIL 30/35-60/95cm	LOWER SUBSOIL 60/95 - 120cm+
A	(SIMCL or occ MSL	SCL, (SIMCL with occ bands of MSL v sli - sli stony	gravelly material or occ C
B	non calc HCL or occ C	non calc C; often with sli stony bands	C occ chalky 95cm+
C	sli calc HCL or occ C	calc C; often chalky 40/50cm+	chalky C

SOURCE MAPS Base maps taken from the OS 1:10000 Sheet TL 72 SE

This map is accurate only at the scale shown.
Any enlargement could be misleading

Scale 1:10 000

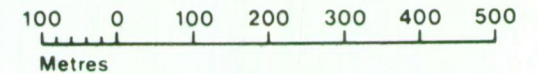

Drawn by the Cartographic Unit,
Farm & Countryside Service
Cambridge, Ref. C 16 90
Ordnance Survey maps reproduced
with the permission of the Controller,
H.M.S.O.
© Crown Copyright reserved 1990

