

Agricultural Land Classification

EAST GATE FARM, URLAY NOOK. Semi-detailed Survey

Agricultural Land

Grade	Quality	Area (ha)
1	Excellent	Nil
2	Very Good	Nil
3a	Good	Nil
3b	Moderate	67.3
4	Poor	Nil
5	Very Poor	Nil

Other Land Categories

Category	Area (ha)
Urban	Nil
Non-Agricultural	Nil
Woodland	Nil
Agricultural Buildings	1.0
Open Water	Nil
Not Surveyed	Nil

Total agricultural land area 67.3
Total survey area 68.3

* Grade/category not present within survey area

Scale - 1:10,000

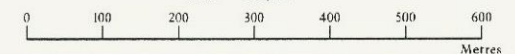

Further details contained in MAFF (1988) Agricultural Land Classification of England and Wales - Revised guidelines and criteria for grading the quality of agricultural land. MAFF (Publications), London SE99 7TP.

The information is accurate at the base map scale but any enlargement would be misleading.

Reproduction in whole or in part by any means is prohibited without the prior permission of MAFF.

Surveyed and drawn by the Resource Planning Team, ADAS Statutory Unit Leeds

Based on the 1988 Ordnance Survey 1:10,000 map with the permission of the Controller of Her Majesty's Stationery Office.

Source Map(s): NZ 31 NE, NZ 31 SE.

Reference no. 218/95

© Crown Copyright Reserved 1995

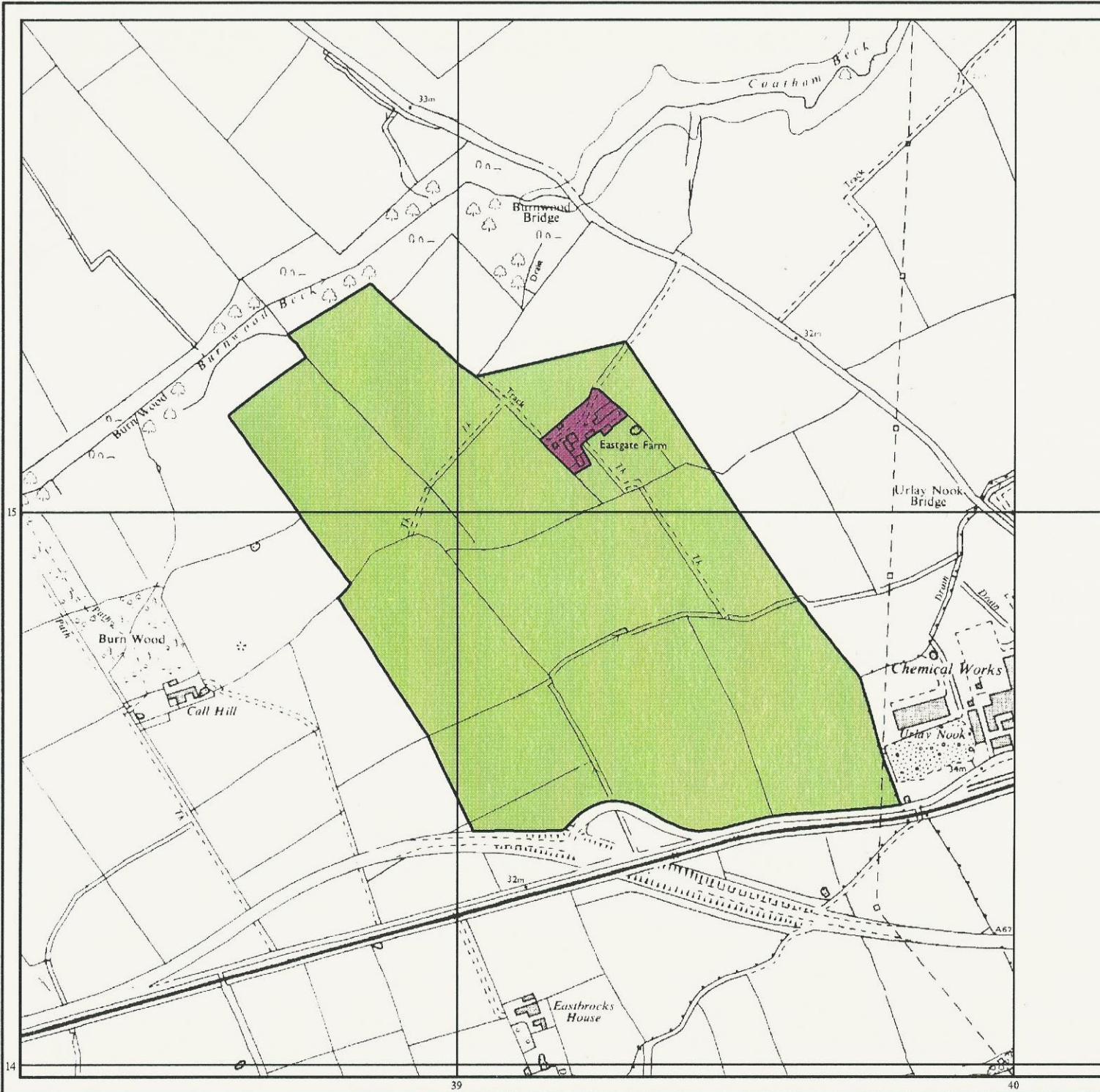

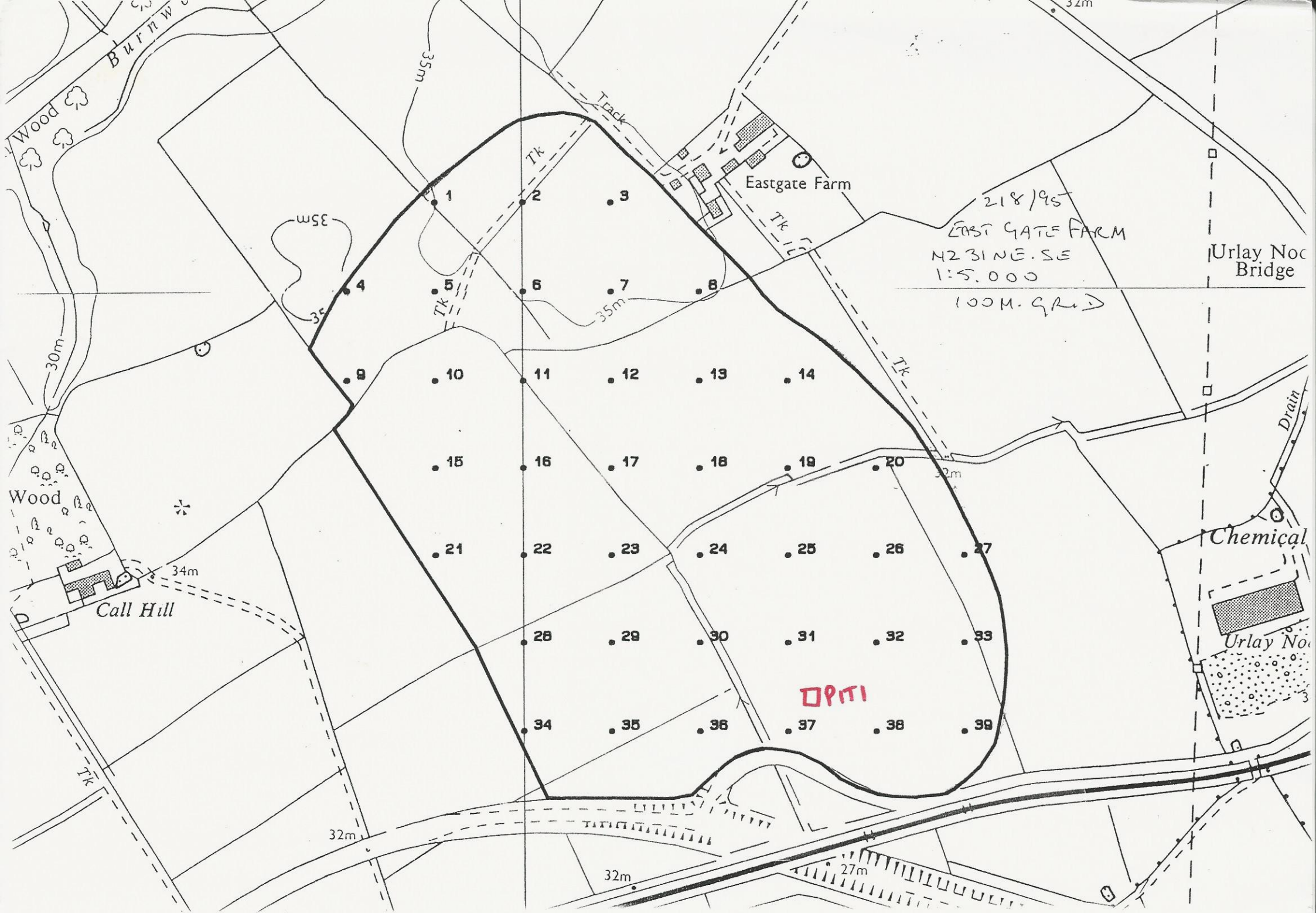

218/95
EAST GATE FARM
N231NE.SE
1:5,000
100M. GRAD

PITI

Chemical
Uraly No.

Uraly No.
Bridge

Eastgate Farm

Call Hill

Wood

Wood

Burn

Track

Drain

27m

32m

32m

34m

30m

35m

35m

32m

32m

35m

35m

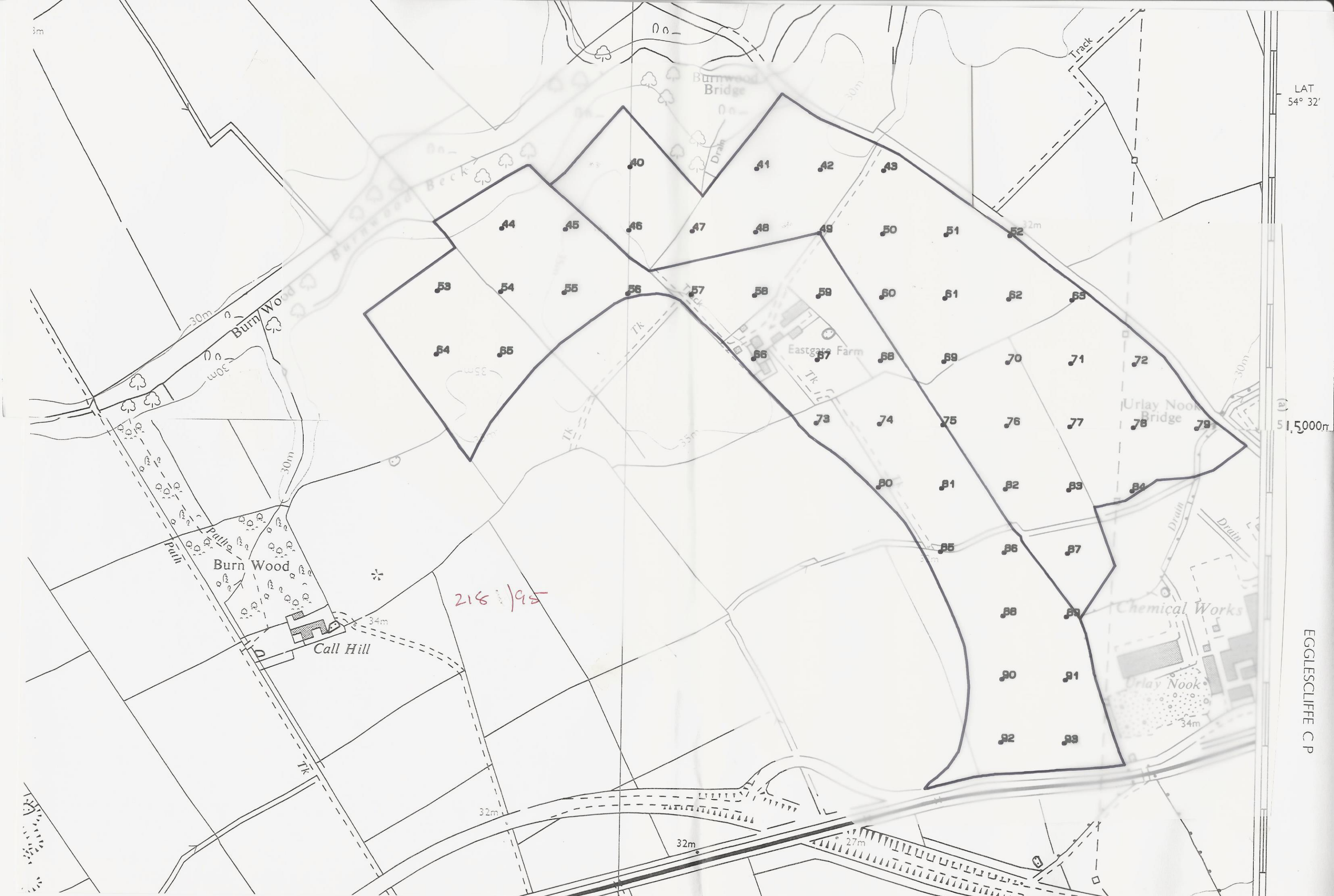

LAT 54° 32'

(a) 51,500m

EGLESLIFFE C P